



Broomhill Close, Great Barr
Birmingham, B43 5BT

£269,500

Great Barr

£269,500



Paul Carr Estate Agents are delighted to offer this renovated and extended two bedroom semi detached Bungalow which is situated within a sought after cul de sac position in Great Barr.

The property comprises of an entrance hallway, shower room, two double bedrooms and a spacious open plan lounge / diner and kitchen.

To the front of the property is a block paved garden with a shared driveway leading to a single garage. The rear garden is mainly laid to lawn with well stocked borders.

The property is located close to local amenities, public transport links and school catchment.





Agent's Note:

Every care has been taken with the preparation of these Sales Particulars but they are for general guidance only and complete accuracy cannot be guaranteed. If there is any point which is of particular importance, professional verification should be sought. The mention of any fixtures, fittings and/or appliances does not imply they are in full efficient working order as they have not been tested. All dimensions are approximate. Photographs are reproduced for general information and it cannot be inferred that any item shown is included in the sale. These Sales Particulars do not constitute a contract or part of a contract.
Came on the market: 25th January 2021

Property Specification

TWO BEDROOM
DOUBLE GLAZING
FITTED KITCHEN
OPEN PLAN LIVING
REFURBISHED

Porch

Hall

Shower Room

Kitchen 2.81m (9'3") x 2.41m (7'11")

Lounge/Diner 7.25m (23'10") x 6.42m (21'1")

Hall

Bedroom One: 3.03m (9'11") x 3.02m (9'11")

Bedroom Two: 3.29m (10'10") x 3.29m (10'10")

Viewer's Note:

Services connected: Gas, Electricity, Water Supply & Drainage
Council tax band: C
Tenure: Freehold

Floor Plan

This floor plan is not drawn to scale and is for illustration purposes only

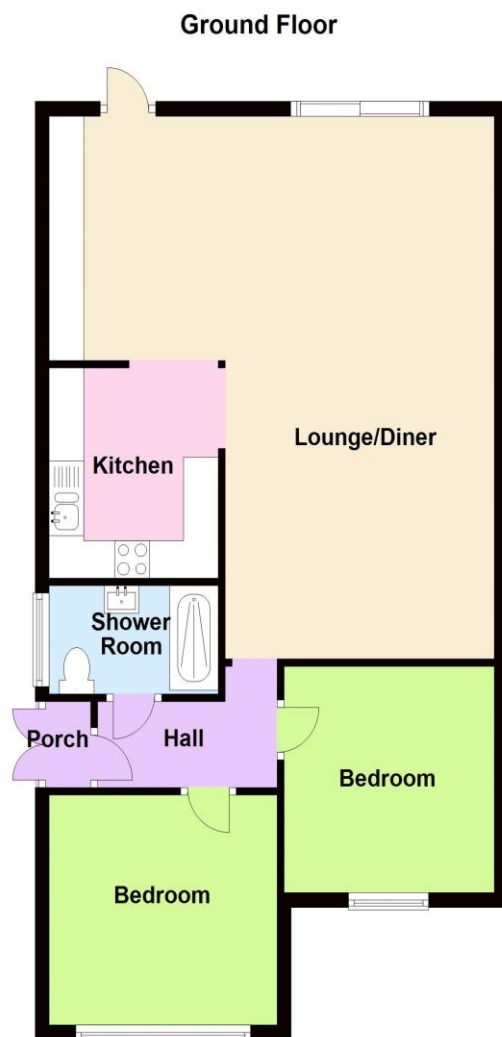

Energy Efficiency Rating

Score	Energy rating	Current	Potential
92+	A		
81-91	B		
69-80	C		77 C
55-68	D	62 D	
39-54	E		
21-38	F		
1-20	G		

Map Location

